

ELOÉ™

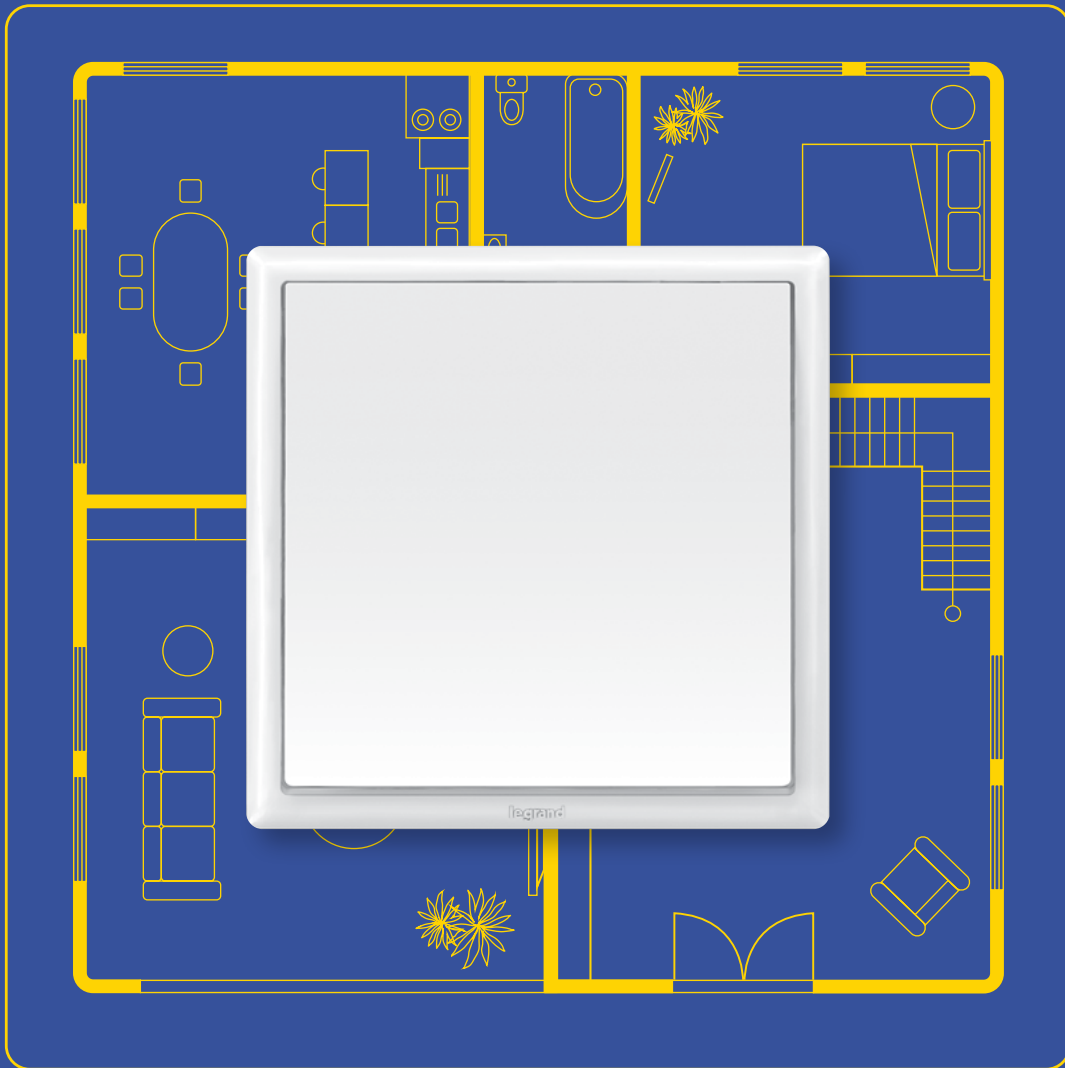

Everything just **ADDS** up

THE GLOBAL SPECIALIST
IN ELECTRICAL AND DIGITAL BUILDING INFRASTRUCTURES

 **legrand**®

ELOÉ™

When you choose **ELOÉ™** for your project, you are not just choosing a modern design and versatile functions, you are also opting for easy installation – and better value. **ELOÉ™** adds to your winning formula.

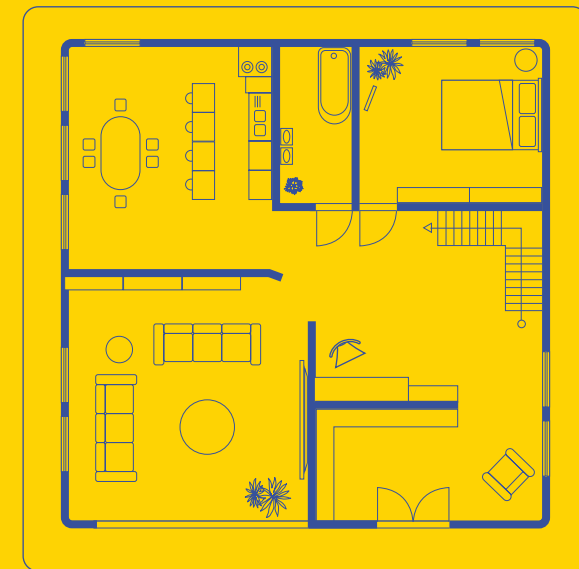

Everything just
ADDS up

CONTENTS

- 02 **ADD DETAILS** that matter
- 04 **ADD VALUE** to your productivity
- 06 **ADD POSSIBILITIES** to projects
- 08 **ADD** a touch of **COMFORT**
- 10 Catalogue pages

ADD DETAILS that matter

Good design doesn't always have to be complex. With **ELOÉ™**, it combines details that make sense and add to the overall experience – for both users and installers.



SUBTLE CURVES
Rounded corners and curves add a touch of elegance.



STRONG PROFILE
Clean lines and a distinct shape enhance the visual appeal of **ELOÉ™**.

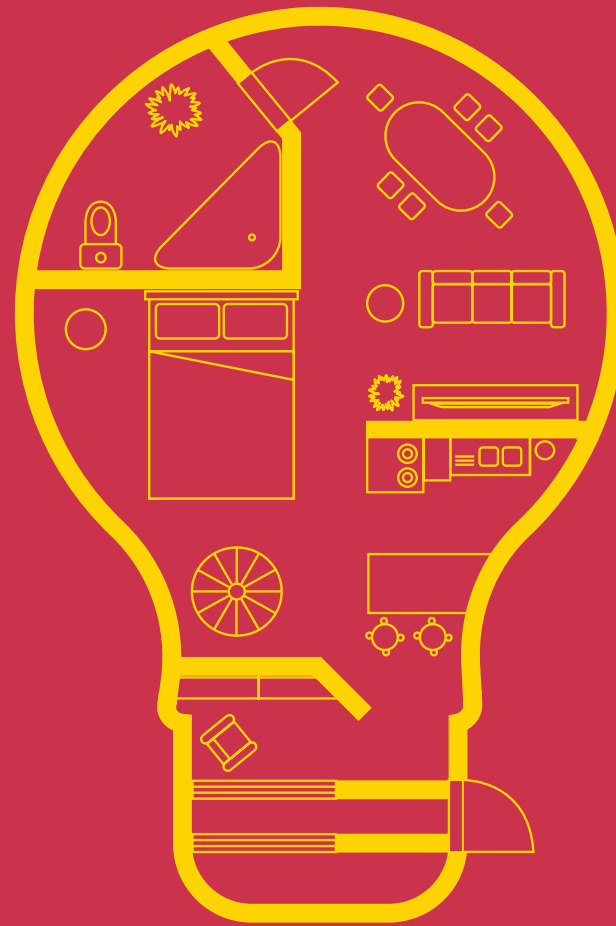

Superior design and quality



GLOSSY FINISH
Smooth glossy surface makes cleaning fuss-free.



COMPLIANT WITH STANDARDS
ELOÉ™ is designed to meet international standards – IEC and BS.



LARGE ROCKER
Ergonomically designed for a great user experience



DESIGNED TO LAST
Even the concealed functional parts have been carefully designed.

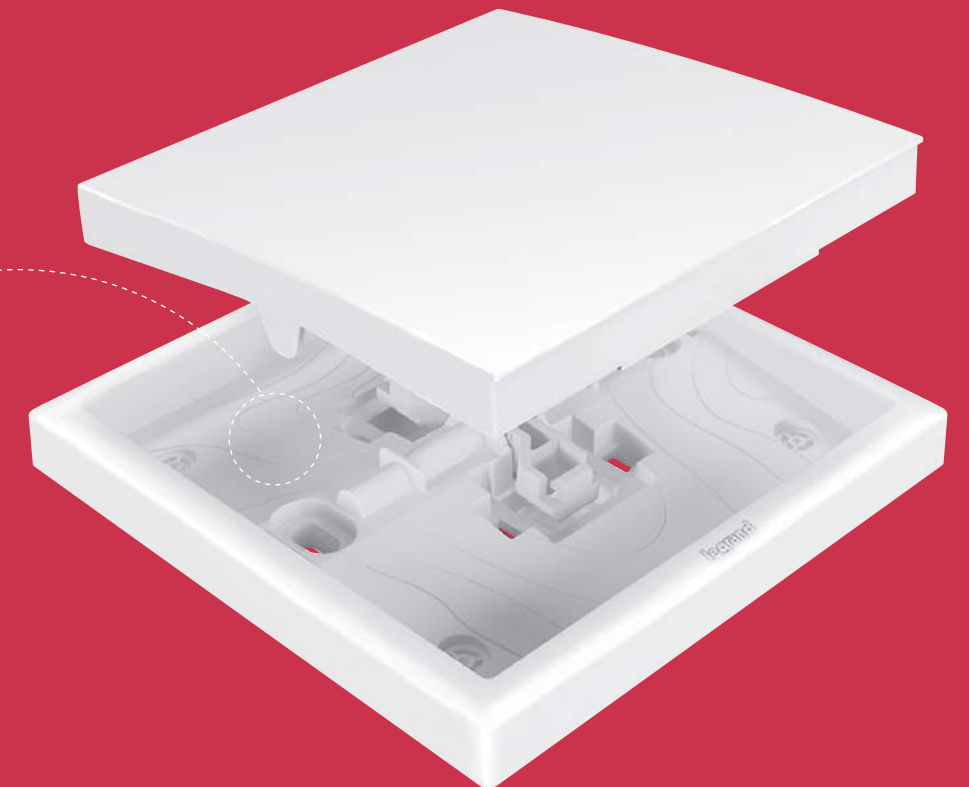

ADD VALUE to your productivity

No matter how unpredictable the conditions at your worksite may be, **ELOÉ™** takes the uncertainty out of your project by making every installation simple, fuss-free, safe, on time – and on budget.



EASY
QUICK

TIME SAVING
Large terminal capacity allows for quick and easy wiring and connection to multiple outlets.



ROBUSTNESS
Ribbs make the switch sturdy.

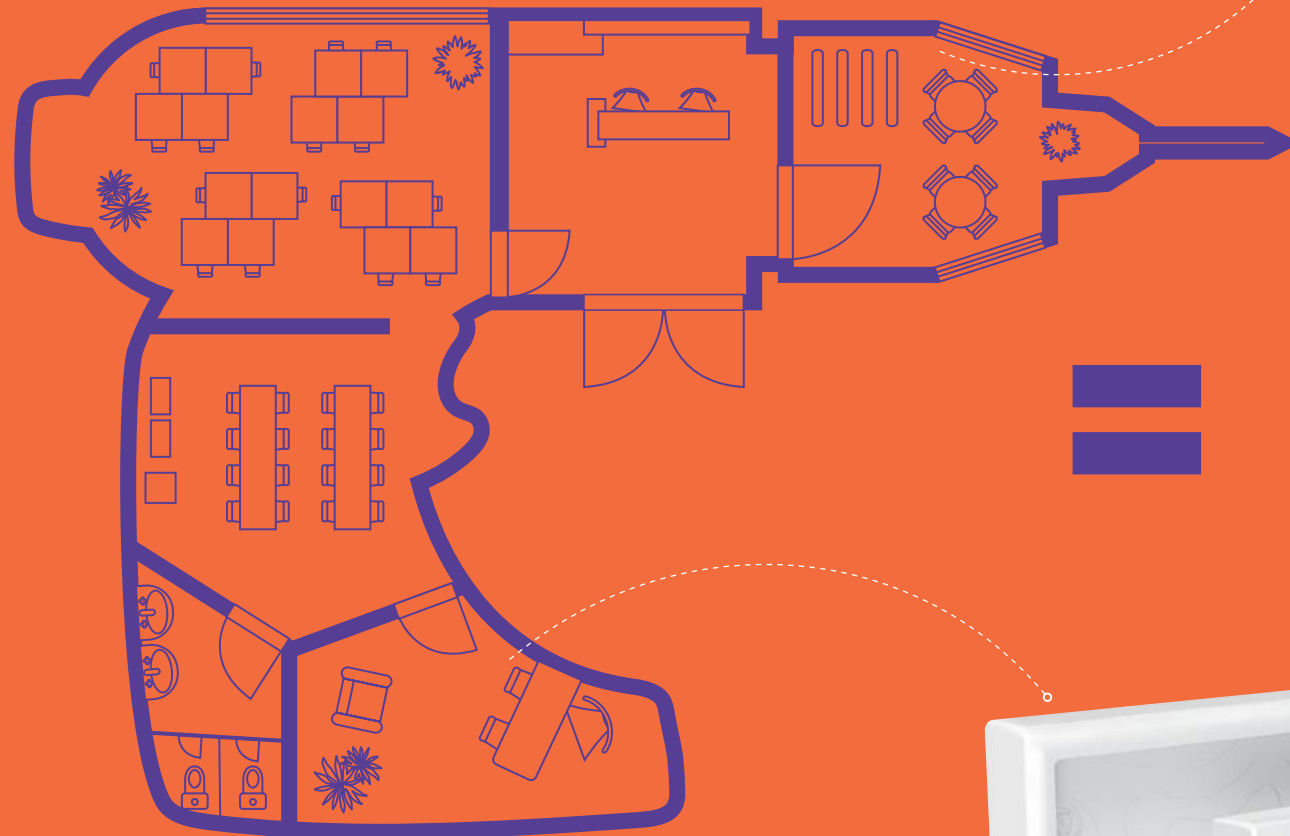

Easy installation



UNIVERSAL SCREW HEADS

For both wiring and adjusting **ELOÉ™**, you need only one screwdriver head to get the installation done.



FLEXIBILITY
Oblong shaped holes ensure flexibility for easy adjustment when the switch is not straight.



EASY TO ORDER
1 catalogue number = 1 complete product



SAFE AND FAST INSTALLATION
No access to metal parts ensures your safety during installation. The one-piece plate/mechanism also means that installation can be completed in three simple steps.

ADD POSSIBILITIES to projects

Whether you are working on an integrated development or a straightforward build, **ELOÉ™** provides the functions you need.



The splash-proof cover allows a 1-gang **ELOÉ™** mechanism to be installed in outdoor environments. It also ensures protection against dust. With plug engaged, IP55 protection is maintained.

1-gang British standard 13A socket with USB Type-C charger and IP55 cover

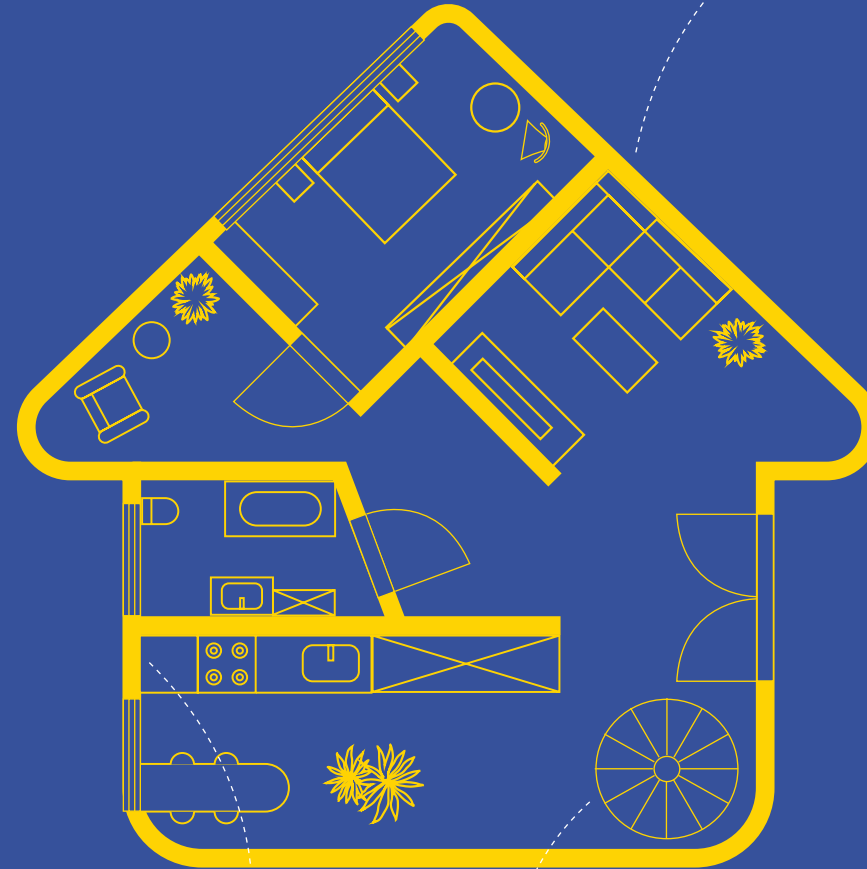

Versatility for modern living



UNIVERSAL DIMMER SUITABLE FOR ALL MODERN LOADS



Dimmable LEDs



Dimmable compact fluorescent lamps



Incandescent and halogen lamps



Halogen lamps with electronic or ferromagnetic transformer

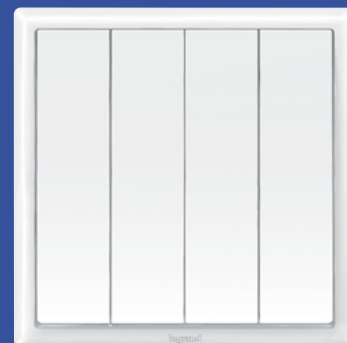

4-gang switch



1-gang British standard switched 13A socket with USB Type-A charger



2x4-gang switch in 2-gang box

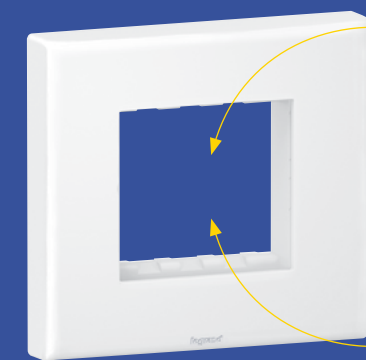

Adapter for Arteor mechanism



Electronic room thermostat



HDMI socket



There is no settling for less. **ELOÉ™** works both independently and with the Arteor range. The Arteor adapter offers versatility for your every need – residential, commercial and hospitality projects.

ADD a touch of COMFORT

Comfort is the cornerstone of any hospitality project. That is why the **ELOÉ™** range provides dedicated hospitality functions for enhancing experiences in both guest rooms and shared spaces.



Key card switch

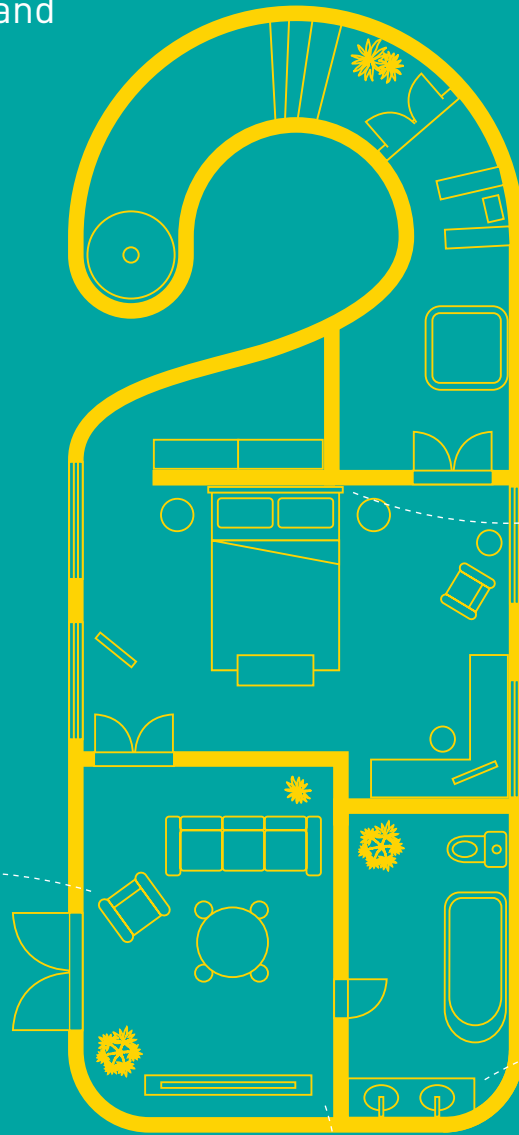

2-gang British standard switched 13A socket with USB Type-A & Type-C dual charger



With this multipurpose socket, you can leave it to **ELOÉ™** to power and charge up your devices while you recharge yourself.



Better hospitality experiences



External indicator for corridor



Internal control unit



Keystone data socket



1-gang Multistandard switched 13A socket with USB Type-A charger

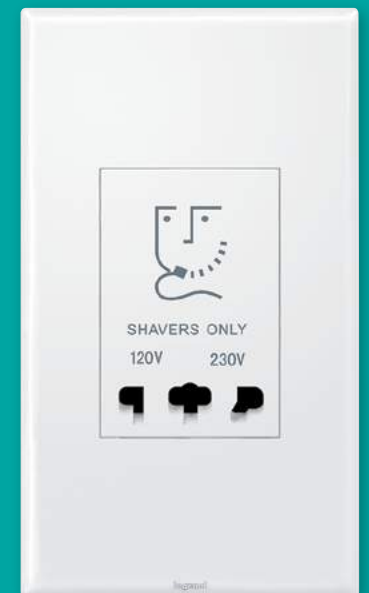

Shaver socket

ELOÉ™

single pole switches and push-buttons



Conform to BS EN 60669-1
 Material: Thermoplastic with glossy finish
 Dimensions: 86 x 86 x 9.5 mm (1-gang) / 86 x 146 x 9.5 mm (2-gang)
 Supplied with 2 screws M3.5 for BS boxes

Pack	Cat.Nos	Single pole switches 16 AX - 250 V~
10	6 180 00	1-gang 1-way switch ○ White
10	6 180 01	1-gang 2-way switch ○ White
10	6 180 02	2-gang 1-way switch ○ White
10	6 180 03	2-gang 2-way switch ○ White
10	6 180 09	Intermediate switch ○ White
10	6 180 04	3-gang 1-way switch ○ White
10	6 180 05	3-gang 2-way switch ○ White
10	6 180 06	4-gang 1-way switch ○ White
10	6 180 07	4-gang 2-way switch ○ White

Pack	Cat.Nos	Single pole switches 16 AX - 250 V~ (continued)
5	6 180 24	2x2-gang 2-way switch ○ White
5	6 180 66	2x3-gang 1-way switch ○ White
5	6 180 68	2x4-gang 1-way switch ○ White

Pack	Cat.Nos	Single pole switches 20 AX - 250 V~
10	6 180 20	1-gang 1-way switch ○ White
10	6 180 22	2-gang 1-way switch ○ White

Pack	Cat.Nos	Push-buttons 6 A - 250 V~
10	6 180 10	1-gang ○ White
10	6 180 15	2-gang ○ White
10	6 180 11	Bell push ○ White
10	6 180 16	2-gang for shutters ○ White

ELOÉ™

double pole switches and cooker control unit



Material: Thermoplastic with glossy finish
 Dimensions: 86 x 86 x 9.5 mm (1-gang) / 86 x 146 x 9.5 mm (2-gang)
 Supplied with 2 screws M3.5 for BS boxes





Pack	Cat.Nos	Double pole switches 20 A - 250 V~
10	6 180 70	1-gang 1-way switch + red neon indicator ○ White
10	6 180 71	1-gang 1-way switch + red neon indicator + 1 earth connection ○ White
10	6 180 71 SH	1-gang 2-way switch + red neon indicator + 2 earth connection ○ White
10	6 180 72	1-gang 1-way switch + red neon indicator + 1 earth connection with "Water Heater" marking ○ White
10	6 180 79	1-gang 2-way switch + red neon indicator + 1 earth connection with "Water Heater" marking ○ White
10	6 180 74	Double pole switches 32 A - 250 V~ 1-gang 1-way switch + red neon indicator ○ White

Pack	Cat.Nos	Double pole switches 45 A - 250 V~
10	6 180 75	1-gang 1-way switch ○ White
10	6 180 76	1-gang 1-way switch + red neon indicator ○ White
5	6 180 77	2-gang 1-way vertical switch + red neon indicator ○ White
5	6 180 78	Cooker control unit - 250 V 45 A double pole switch + red neon and 13 A BS switched socket outlet + red neon ○ White



6 180 35 6 180 96

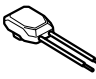
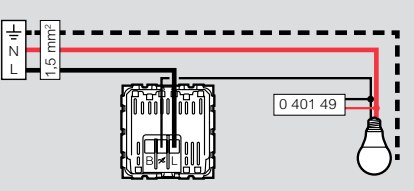





Material: Thermoplastic with glossy finish
Dimensions: 86 x 86 x 9.5 mm (1-gang)
Supplied with 2 screws M3.5 for BS boxes

Pack	Cat.Nos	Dimmers
1	6 180 31	500 W RL dimmer Push on/off and rotary dimmer - 50/60 Hz 1-gang 2-way : - 60-500W (230 V) for halogen lamps with electronic transformer with leading edge behaviour ○ White 
1	6 180 35	200W LED + 300W Incandescent Rotary dimmer For all types of lamps: - dimmable LEDs: 5 W to 200 W (10 lamps max. 5 W to 37 W (100 V)) - dimmable compact fluorescent lamps: 5 W to 75 W (10 lamps max. 5 W to 37 W (100 V)) - halogen with ferromagnetic or electronic transformer: 5 VA to 300 VA / 5 VA to 150 VA (100 V) - fluorescent tube - ballast: 5 VA to 300 VA / 5 VA to 150 VA (100 V) - halogen and incandescent 240 V 5 W to 300 W / 5 W to 150 W (100 V) When switched on, gradually (2 seconds) lights up at the level set before last switch-off ○ White 
1	0 401 49	Active Power Compensator Makes 2-wire electronic lighting control units without neutral compatible with all commercially-available loads (LED, compact fluorescent, ELV halogen with ferromagnetic or electronic ballast, 230 V halogen, fluorescent tube, incandescent) Consumption 0.4 W  
1	6 180 96	5-speed fan control Conform to BS EN 60669-2-1 Fan control 240 V ~ - 50 Hz 100VA ○ White 



6 180 27 6 180 38 6 180 95





Material: Thermoplastic with glossy finish
Dimensions: 86 x 86 x 9.5 mm (1-gang)
Supplied with 2 screws M3.5 for BS boxes

Pack	Cat.Nos	Television sockets
10	6 180 27	Single TV socket, female ○ White 
10	6 180 26	Single TV socket, F-type ○ White 
10	6 180 38	Double TV socket, female + SAT, F-type ○ White 
5	6 180 32	TV-R-SAT socket ○ White 
Pack	Cat.Nos	Telephone sockets
5	6 180 95	BS master ○ White 
10	6 180 97	RJ 11 socket ○ White 



6 180 93 6 180 34





Material: Thermoplastic with glossy finish
Dimensions: 86 x 86 x 9.5 mm (1-gang)
Supplied with 2 screws M3.5 for BS boxes

Pack	Cat.Nos	Data sockets
10	6 180 93	RJ 45 Cat.5 UTP ○ White 
10	6 180 91	RJ 45 Cat.6 UTP ○ White 
10	6 180 92	Double RJ 45 Cat.6 UTP ○ White 
10	6 180 17	1-gang - single Keystone adaptor ○ White 
10	6 180 34	1-gang - double Keystone adaptor ○ White 

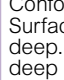

6 180 12 6 180 18 6 180 37 + 5 720 78

Material: Thermoplastic with glossy finish
Dimensions: 86 x 86 x 9.5 mm (1-gang) / 86 x 146 x 9.5 mm (2-gang)
Supplied with 2 screws M3.5 for BS boxes

Pack	Cat.Nos	Key card switch
1	6 180 12	16 A - 230 V ~ - 50/60 Hz Time delay of approx. 30 s after card removal Use card with width max. 54 mm ○ White 
Pack	Cat.Nos	Hotel bedroom call indicators
10	6 180 13	Enable the resident to inform hotel staff of the room status. 2 settings: - Do not disturb - Make up room ○ White 
10	6 180 14	External Indicator for corridor Installed in the corridor, displays calls ○ White 
10	6 180 14	Internal control unit Installed in the room, allows the user to select the desired setting ○ White 
Pack	Cat.Nos	Shaver sockets
1	6 180 18	Conform to BS 61558. 115/230 V - 20 VA - 50/60 Hz Surface or flush-mounting, back box to be min. 47 mm deep. Spacer delivered to fit in standard box, 35 mm deep 2-gang ○ White 
Pack	Cat.Nos	Arteor adaptor
10	6 180 37	Allows the integration of 2-module Arteor mechanisms such as R.C.B.O., automatic switch, skirting light, USB charger, etc 1-gang ○ White 





Material: Thermoplastic with glossy finish
 Dimensions: 86 x 86 x 9.5 mm (1-gang) / 86 x 146 x 9.5 mm (2-gang).
 Supplied with 2 screws M3.5 for BS boxes

Pack	Cat.Nos	British Standard socket outlets 13 A - 250 V~
10	6 180 41	Conform to BS 1363-2 1-gang single pole switched ○ White
5	6 180 46	2-gang single pole switched ○ White
10	6 180 40	1-gang unswitched ○ White
5	6 180 45	2-gang unswitched ○ White
10	6 180 43	1-gang double pole switched ○ White
5	6 180 73	1-gang double pole switched 2 earth terminal ○ White
5	6 180 48	2-gang double pole switched ○ White
10	6 180 42	1-gang single pole switched + neon ○ White
5	6 180 47	2-gang single pole switched + neon ○ White
5	6 180 49	2-gang single pole switched with red cover + neon ● Red

Pack	Cat.Nos	British Standard socket outlets 13 A - 250 V~ with USB charger
1	6 180 58	Conform to BS 1363-2 Conform to IEC 60950-1 1-gang single pole switched with USB Type-A 3 A - 5 V _{DC} 15 W Consumption in passive mode < 0.08 W ○ White
1	6 180 57	1-gang unswitched with USB Type-A 3 A - 5 V _{DC} 15 W Consumption in passive mode < 0.08 W ○ White
1	6 180 30	1-gang unswitched with USB Type-C 3 A - 5 V _{DC} 15 W Consumption in passive mode < 0.08 W ○ White
1	6 180 44	2-gang single pole switched with USB Type-A + Type-C 3 A - 5 V _{DC} 15 W Consumption in passive mode < 0.08 W ○ White
10	6 180 51	Conform to BS 546 1-gang single pole switched ○ White
5	6 180 52	1-gang single pole switched + neon ○ White
5	6 180 53	2-gang single pole switched ○ White
10	6 180 54	Conform to BS 546 1-gang single pole switched ○ White



Material: Thermoplastic with glossy finish
 Dimensions: 86 x 86 x 9.5 mm (1-gang) / 86 x 146 x 9.5 mm (2-gang)
 Supplied with 2 screws M3.5 for BS boxes

Pack	Cat.Nos	Euro/US socket outlets - 16 A - 250 V~ / 15 A - 127 V~
10	6 180 62	1-gang 2 x 2P ○ White
10	6 180 90	1-gang 2 x 2P switched ○ White
10	6 180 64	1-gang 2 x 2P+E ○ White
10	6 180 56	German Standard socket outlet 16 A - 250 V~ 1-gang 2P+E with shutters for child protection ○ White
10	6 180 67	Multistandard switched socket outlet 15 A 127 V~ / 16 A 250 V~ 1-gang ○ White
5	6 180 69	2-gang ○ White

Pack	Cat.Nos	Multistandard switched socket and Euro/ US socket outlets
10	6 180 65	1-gang ○ White
1	6 180 59	Multistandard switched socket outlets 16 A 250 V~ / 15 A - 127 V~ with USB charger Shuttered for child safety USB charger conform to IEC 60950-1 1-gang 2P+E with USB Type-A 3 A - 5 V _{DC} 15 W Consumption in passive mode < 0.08 W ○ White
1	6 180 55	2-gang 2 x 2P+E with USB Type-A + Type-C 3 A - 5 V _{DC} 15 W Consumption in passive mode < 0.08 W ○ White



6 180 82

6 180 85

Material: Thermoplastic with glossy finish
 Dimensions: 86 x 86 x 9.5 mm (1-gang) / 86 x 146 x 9.5 mm (2-gang)
 Supplied with 2 screws M3.5 for BS boxes

Fused connection units 13 A

Pack	Cat.Nos	Description
10	6 180 80	Conform to BS 1363-4 Unswitched + cord outlet ○ White
5	6 180 81	Switched + cord outlet ○ White
10	6 180 60	Unswitched + neon + cord outlet ○ White
10	6 180 82	Switched + neon + cord outlet ○ White

Cable outlets
 Conform to BS 5733

10	6 180 85	20 A - 250 V~ ○ White
10	6 180 86	45 A - 250 V~ ○ White



6 180 28

6 180 37 + 5 720 72

6 176 36 + 6 180 30

Blanking plates

Pack	Cat.Nos	Description
10	6 180 28	Conform to IEC 60670-1 1-gang ○ White
10	6 180 39	2-gang ○ White

Arteor adaptor
 Allows the integration of 2-module Arteor mechanisms such as R.C.B.O., automatic switch, skirting light, USB charger, etc

10	6 180 37	1-gang ○ White
----	----------	--------------------------

Fixing accessories
Splash-proof cover
 Mainly for socket protection IP 55 with or without plug engaged
 Space inside : 86 x 86 mm
 External dimensions : 129,2 x 107,2 x 54,1 mm

4	6 176 36	● Mist grey
---	----------	-------------

Surface-mounting boxes

Pack	Cat.Nos	Description
8	6 133 50	Conform to BS 5733 Depth 35 mm 1-gang ○ White
4	6 133 51	2-gang ○ White

For integration of Arteor functions, see **Arteor offer**

