

SKQ1 SERIES CB CLASS ATS (MOTOR DRIVEN TYPE)

PRODUCT OVERVIEW

- SKQ1 series dual power automatic transfer switch is the second generation ATS. It is CB Class and its usage category is AC-33B non-frequently operable electrical transfer switch. It has 3 working modes: Automatic(Type A), Electric(Type B) and Emergency Manual. ASKQ is suitable to be used in the 50/60Hz low voltage AC power distribution systems for the reliable transfer between two power supplies.

QUICK SELECTION TABLE

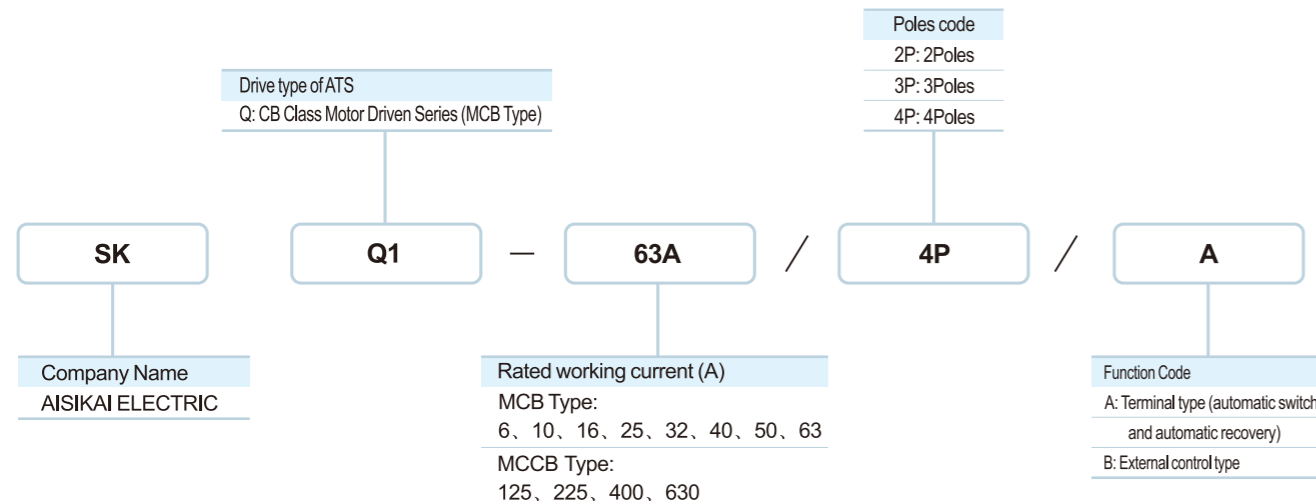

PERFORMACE CHARACTERISTICS

- Reasonable in structure, small in volume, beautiful in appearance. Much safer and more reliable in power supply with the protective cover.
- Complete protection functions, provided with protection of short-circuit, overload and etc.
- Noise-free operation, energy saving and consumption reducing, convenient in installation, easy in operation, reliable and stable in performance.
- The interior adopts D type miniature circuit breaker .

Normal working conditions and installation methods

Category	Requirements
Operating temperature	-5 to 40℃. The average value for 24 hours shall not exceed +35℃ ;
Operating humidity	The average humidity at +40℃ shall not exceed 50% ; higher humidity is allowed at a lower temperature, for example, 90% at +25℃. Special measures should be taken when occasionally there is condensation on the products due to temperature changes
Altitude	Lower than 2000 meters and, if higher than 2000 meters, please use reduce product rated value for use
Vibration and gas	There shall be no strong vibration or shock and no harmful gases to corrode the metals and to damage the insulation within the environment of its use
Surrounding material	There shall be no serious dust, conductive particles or explosive hazardous substances
Class of pollution	Class III in accordance with GB/T14048.11
Installation category	Category III in accordance with GB/T14048.11

STRUCTURE INTRODUCTION (SKQ1 6A~63A)

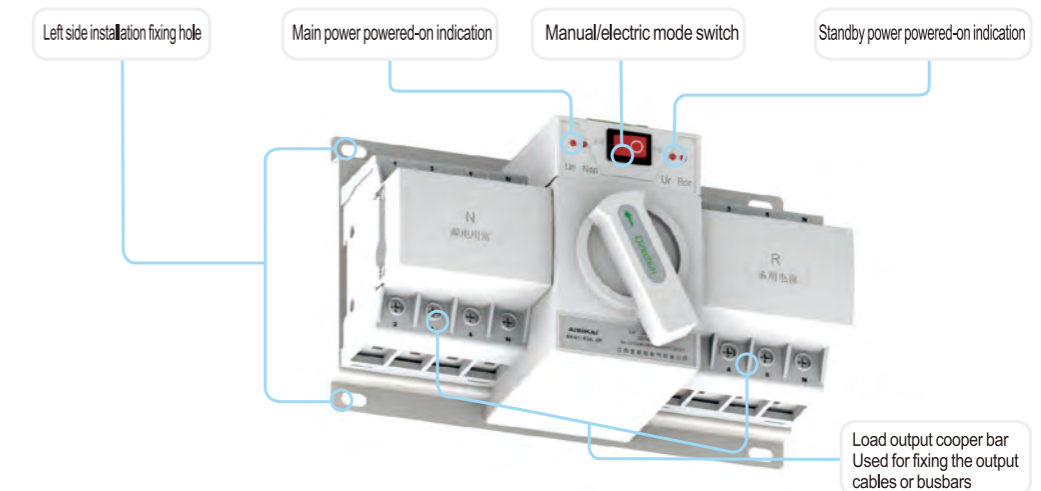
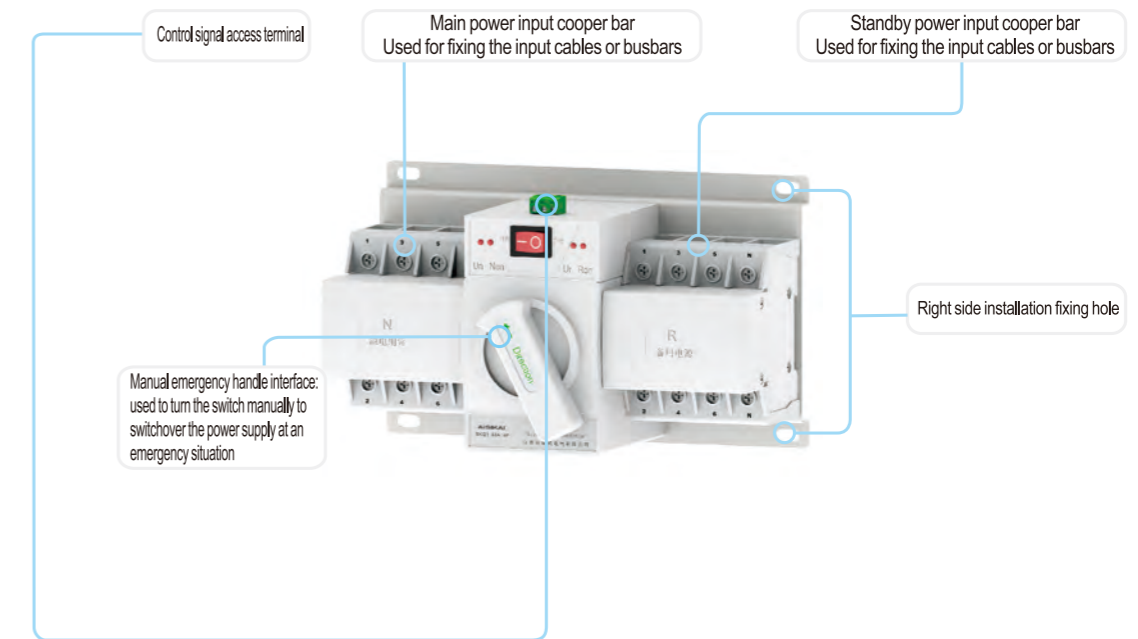

MAIN TECHNICAL PARAMETERS

Rated short-circuit breaking capacity	5KA
Rated short-circuit making capacity	5KA
Transfer time	< 3s
Control voltage of transfer switch	230V
Service life of transfer switch	Mechanical: 3000 times; Electrical: 1500 times
Rated insulation voltage of copper bar Ui	U=400V
Rated operating voltage of copper bar Ue	2P switch is AC220V
Rated operating current of copper bar Ie	10A、16A、20A、25A、32A、40A、63A

Making and breaking capacity

Usage category	Making and breaking test conditions					
	L/Ie	u/ue	cosΦ	Power-on time (s)	Cycle period (min)	Operating cycles
AC-33iB	6.0	1.05	0.5	0.05	≤5	12

Note: The motor load under the non-frequent operation of AC-33iB may include the hybrid load of the motor and the resistance load.

OUTLINE DIMENSIONS DIAGRAM

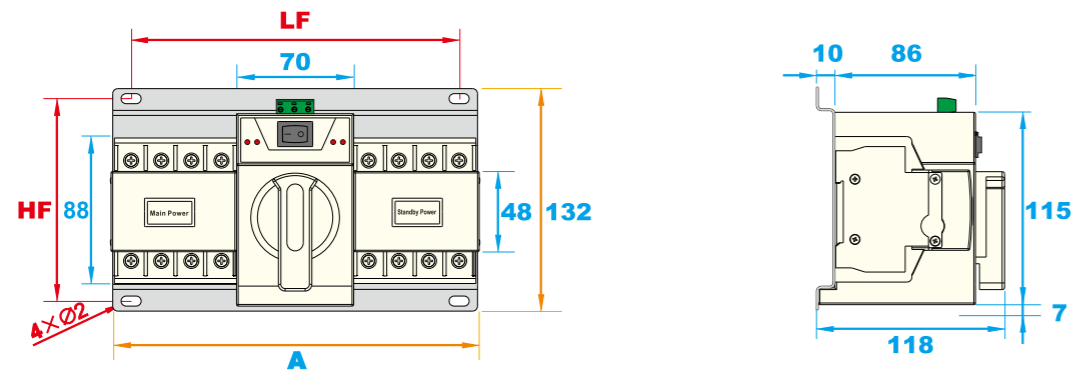

	LF	HF	A
4P	200	120	220
3P	164	120	184
2P	128	120	148

TYPICAL WIRING DIAGRAM

Primary wiring schematic diagram

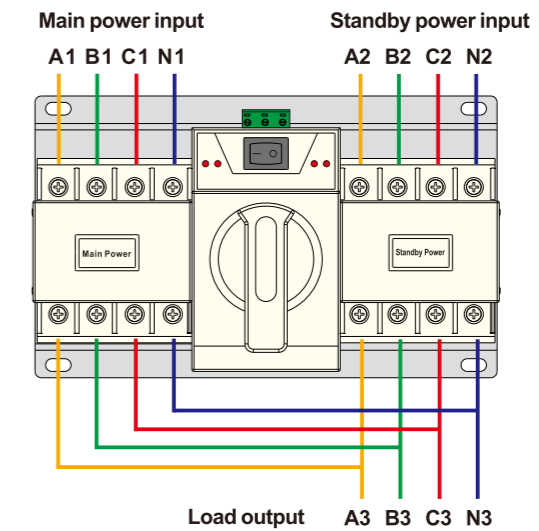

Secondary wiring schematic diagram

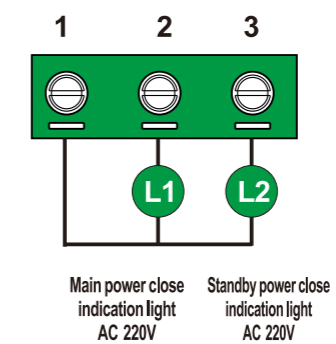

Note:

1. According to the actual requirements of distribution line, connect the main power and standby power input terminals properly and, having verified that the phase sequences of both power supplies are consistent, connect the load output terminals in parallel.
2. When needing manual operation, first set the button in Manual position, then turn the handle to transfer.

STRUCTURE INTRODUCTION (SKQ1 125A~630A)

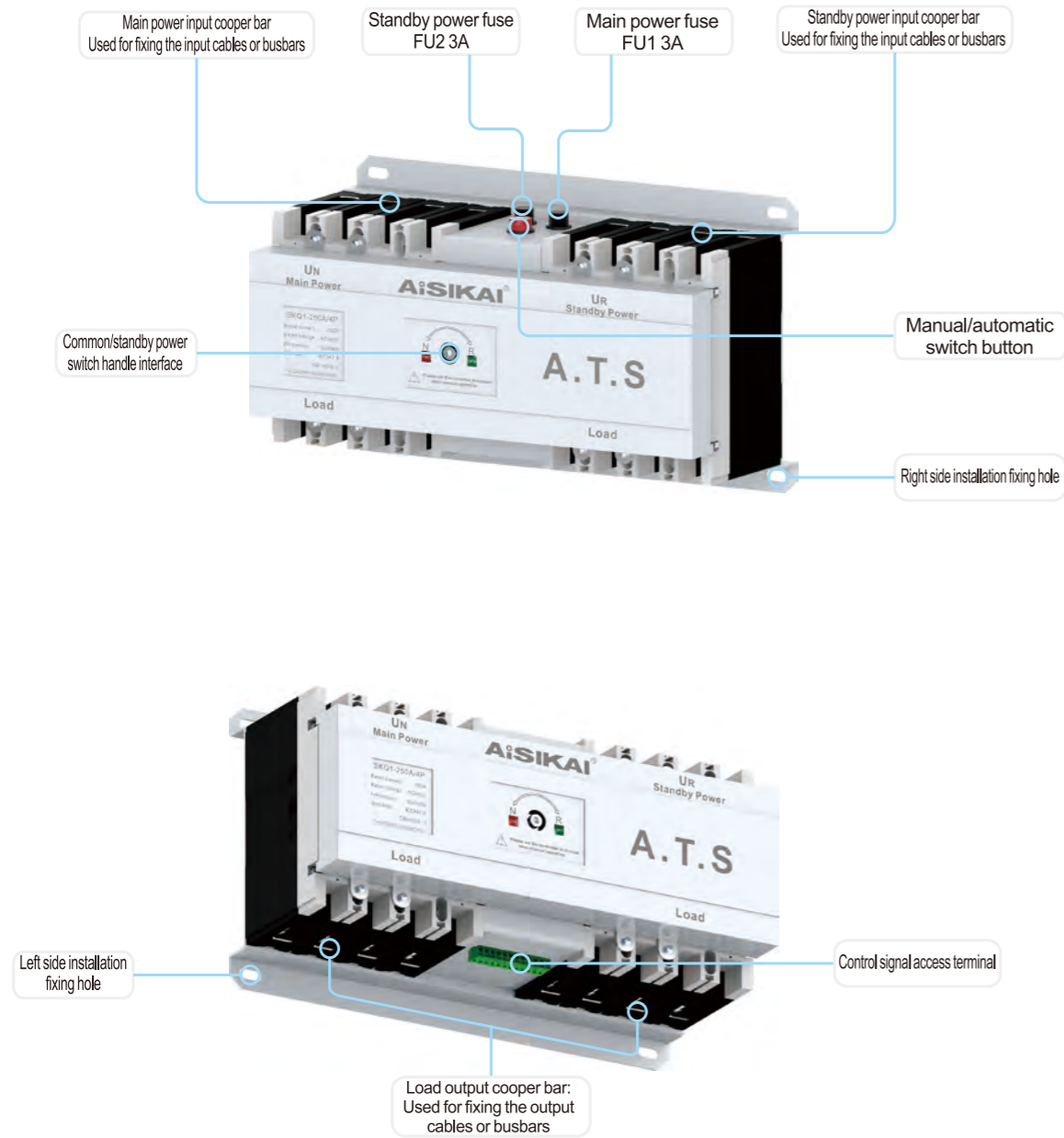

MAIN TECHNICAL PARAMETERS

	SKQ1-125	SKQ1-225	SKQ1-400	SKQ1-630
Usage category	AC-33iB			
Rated current Ie	63A、80A、100A、125A	140A、160A、200A、225A	400A	400A、500A、630A
Rated working voltage Ue	AC400V			
Rated insulation voltage Ui	690V			
Rated short time withstand voltage Icw	10kA	10kA	12.6kA	12.6kA
Rated short-circuit making capacity Icm	17kA	17kA	25.2kA	25.2kA
Service life	Mechanical	10000	5000	
	Electrical	5000	2500	
Pole numbers	3P、4P			
Test operating cycles(seconds/time)	15s			
Transfer time	1~99s(delay)			

Outline and installation dimensions

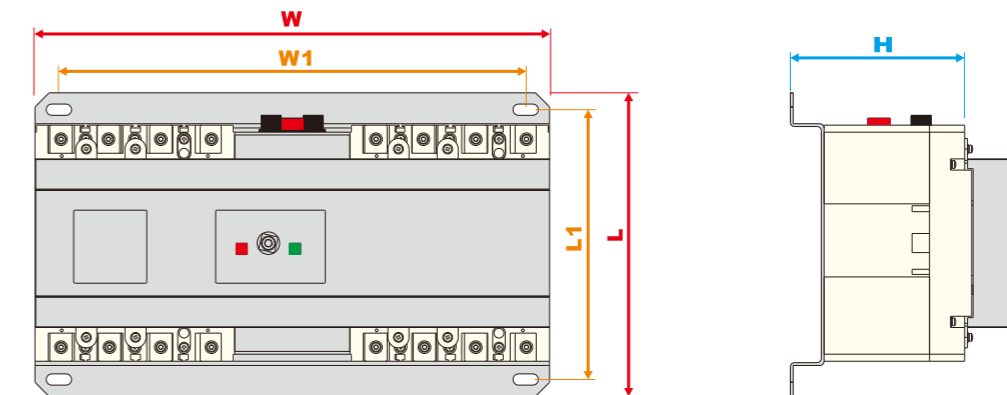

Specification	Dimension	W	L	H	W1	L1
125A/3P		290	205	120	253	186
125A/4P		320	205	120	282	186
225A/3P		330	215	140	296	195
225A/4P		365	215	140	333	195
400A/3P		465	310	190	410	285
400A/4P		505	310	190	455	285
630A/3P		528	318	195	478	295
630A/4P		588	318	195	535	295

WIRING DIAGRAM

Primary wiring schematic diagram

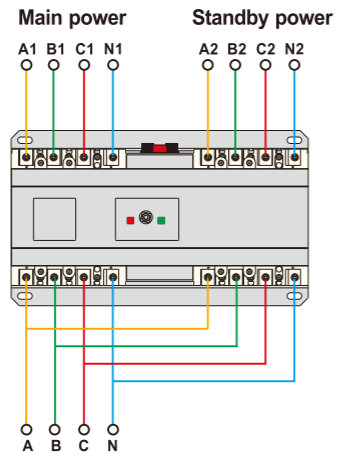

Secondary wiring schematic diagram: full-automatic transfer

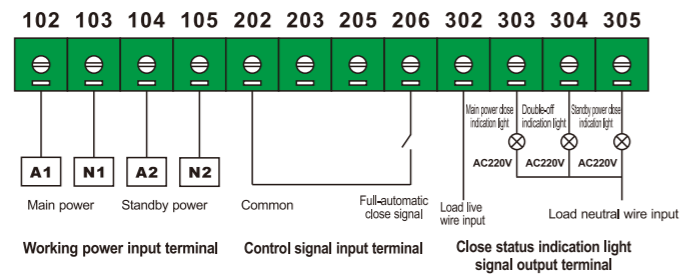

Secondary wiring schematic diagram: remote control electrical transfer

